

QJ-VR-X2.0 VARIABLE RATE HOSE BARB FERTILIZER ASSEMBLY

FEATURES:

- DESIGNED FOR USE IN FLOWMETER-BASED APPLICATION SYSTEMS
- AVAILABLE FOR 3/8" (9.53 MM) & 1/2" (12.7 MM) I.D. HOSE
- HOSE BARB AVAILABLE IN STAINLESS STEEL AND NYLON
- REMOVABLE VARIABLE RATE ORIFICE (EPDM) FOR EASY CLEANING
- VARIABLE RATE FOR A WIDE RANGE OF APPLICATION SPEEDS AND RATES
- NYLON, ACETAL & EPDM CONSTRUCTION FOR EXCELLENT CHEMICAL RESISTANCE
- RECOMMENDED OPERATING PRESSURE: 1.0 - 7.0 BAR (10 - 100 PSI)

TYPICAL APPLICATIONS:

- EXCELLENT FOR VARIABLE RATE APPLICATION OF LIQUID FERTILIZER
- EXCELLENT FOR MAINTAINING A FIXED RATE OVER A WIDE RANGE OF SPEEDS

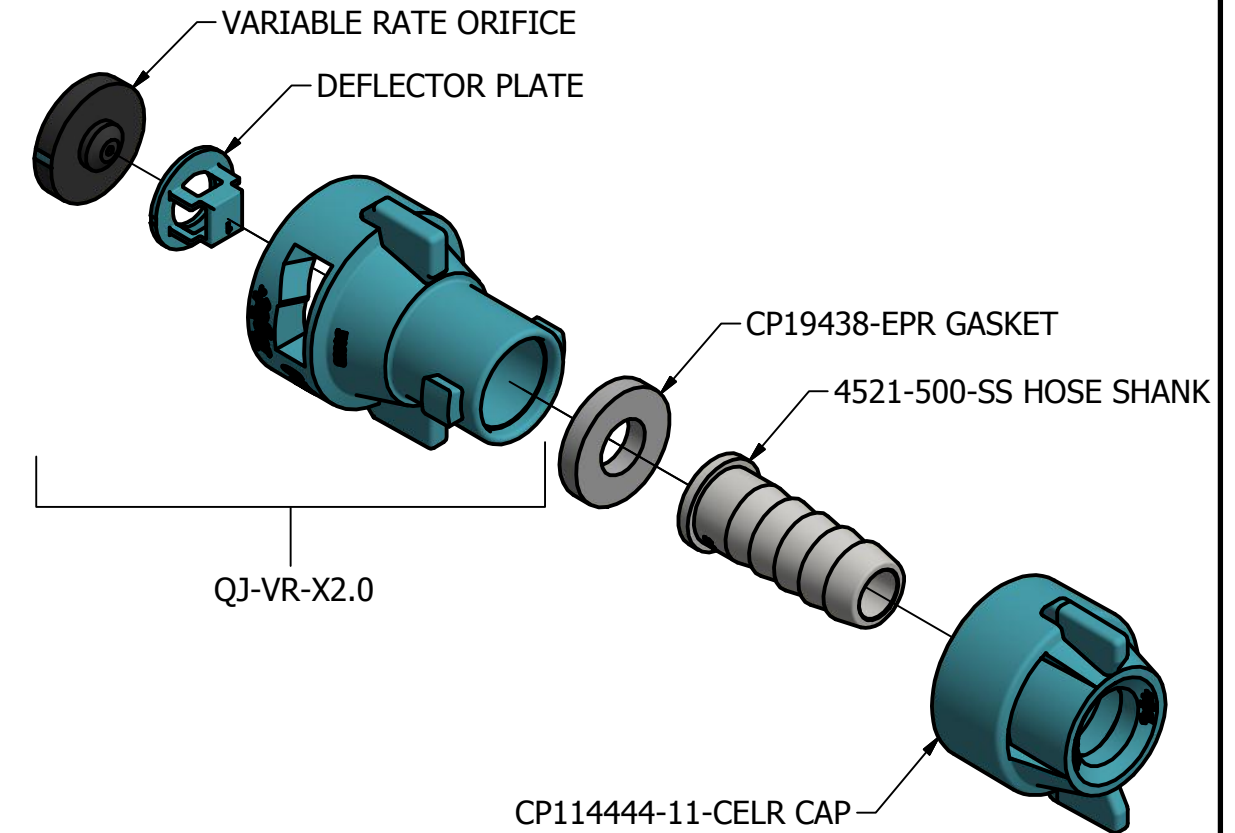
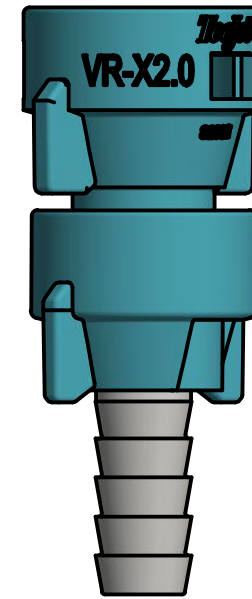

QJ-VR-X2.0 VARIABLE RATE HOSE BARB FERTILIZER NOZZLE										
TIP NO. (STRAINER MESH SIZE)	LIQUID PRESSURE IN BAR	CAPACITY 1 NOZZLE IN L/MIN	75 CM SPACING							
			LITERS PER HECTARE							
			8 KM/H	10 KM/H	12 KM/H	16 KM/H	20 KM/H	25 KM/H	30 KM/H	35 KM/H
QJ-VR-X2.0 (50)	1.0	1.78	178	142	119	89.0	71.2	57.0	47.5	40.7
	1.5	2.17	217	174	145	109	86.8	69.4	57.9	49.6
	2.0	2.58	258	206	172	129	103	82.6	68.8	59.0
	2.5	3.01	301	241	201	151	120	96.3	80.3	68.8
	3.0	3.45	345	276	230	173	138	110	92.0	78.9
	3.5	3.92	392	314	261	196	157	125	105	89.6
	4.0	4.41	441	353	294	221	176	141	118	101
	5.0	5.44	544	435	363	272	218	174	145	124
	6.0	6.55	655	524	437	328	262	210	175	150
7.0	7.75	775	620	517	388	310	248	207	177	

FERTILIZER SPECIFIC GRAVITY CONVERSION FACTORS:

DENSITY OF SOLUTION	CONVERSION FACTOR
0.84 KG/L	0.92
0.96 KG/L	0.98
1.00 - WATER	1.00
1.08 KG/L	1.04
1.20 KG/L	1.10
1.28 - 28% NITROGEN	1.13
1.32 KG/L	1.15
1.44 KG/L	1.20
1.68 KG/L	1.30

NOTE: CONVERSION FACTORS MUST BE USED WHEN SPRAYING SOLUTIONS HEAVIER OR LIGHTER THAN WATER. FIRST, MULTIPLY DESIRED APPLICATION RATE BY THE APPROPRIATE CONVERSION FACTOR ABOVE. THEN USE THE NEW APPLICATION RATE TO SELECT THE MOST APPROPRIATE OPERATING PRESSURE FROM THE APPLICATION CHART ON THIS PAGE.

- * APPLICATION DATA IS BASED ON SPRAYING WATER AT 21 DEG C (70 DEG F).
- * FLOW RATES ARE MEASURED AVERAGES BETWEEN 3/8" (9.53 MM) & 1/2" (12.7 MM) VERSIONS.
- * DEFLECTOR PLATE REQUIRED TO MAINTAIN PUBLISHED FLOW RATES AND STEADY STREAM.

HOW TO ORDER:

QJ-VR-X2.0-3/8-SS - VARIABLE RATE FERTILIZER ASSEMBLY WITH STAINLESS STEEL 3/8" HOSE BARB
 QJ-VR-X2.0-1/2-NYB - VARIABLE RATE FERTILIZER ASSEMBLY WITH NYLON 1/2" HOSE BARB

DESCRIPTION: APPLICATION RATES FOR QJ-VR-X2.0-3/8 & QJ-VR-X2.0-1/2 VARIABLE RATE HOSE BARB FERTILIZER ASSEMBLY (METRIC)		
	REVISION NO. 1	DATASHEET DSQJ-VR-X2.0M
	REFERENCE: 5/10/2017	SHEET: DWG SIZE: B