

QJ-VR-X2.0 VARIABLE RATE HOSE BARB FERTILIZER ASSEMBLY

FEATURES:

- DESIGNED FOR USE IN FLOWMETER-BASED APPLICATION SYSTEMS
- AVAILABLE FOR 3/8" & 1/2" I.D. HOSE
- HOSE BARB AVAILABLE IN STAINLESS STEEL AND NYLON
- REMOVABLE VARIABLE RATE ORIFICE (EPDM) FOR EASY CLEANING
- VARIABLE RATE FOR A WIDE RANGE OF APPLICATION SPEEDS AND RATES
- NYLON, ACETAL & EPDM CONSTRUCTION FOR EXCELLENT CHEMICAL RESISTANCE
- RECOMMENDED OPERATING PRESSURE: 10 - 100 PSI (1.0 - 7.0 BAR)

TYPICAL APPLICATIONS:

- EXCELLENT FOR VARIABLE RATE APPLICATION OF LIQUID FERTILIZER
- EXCELLENT FOR MAINTAINING A FIXED RATE OVER A WIDE RANGE OF SPEEDS

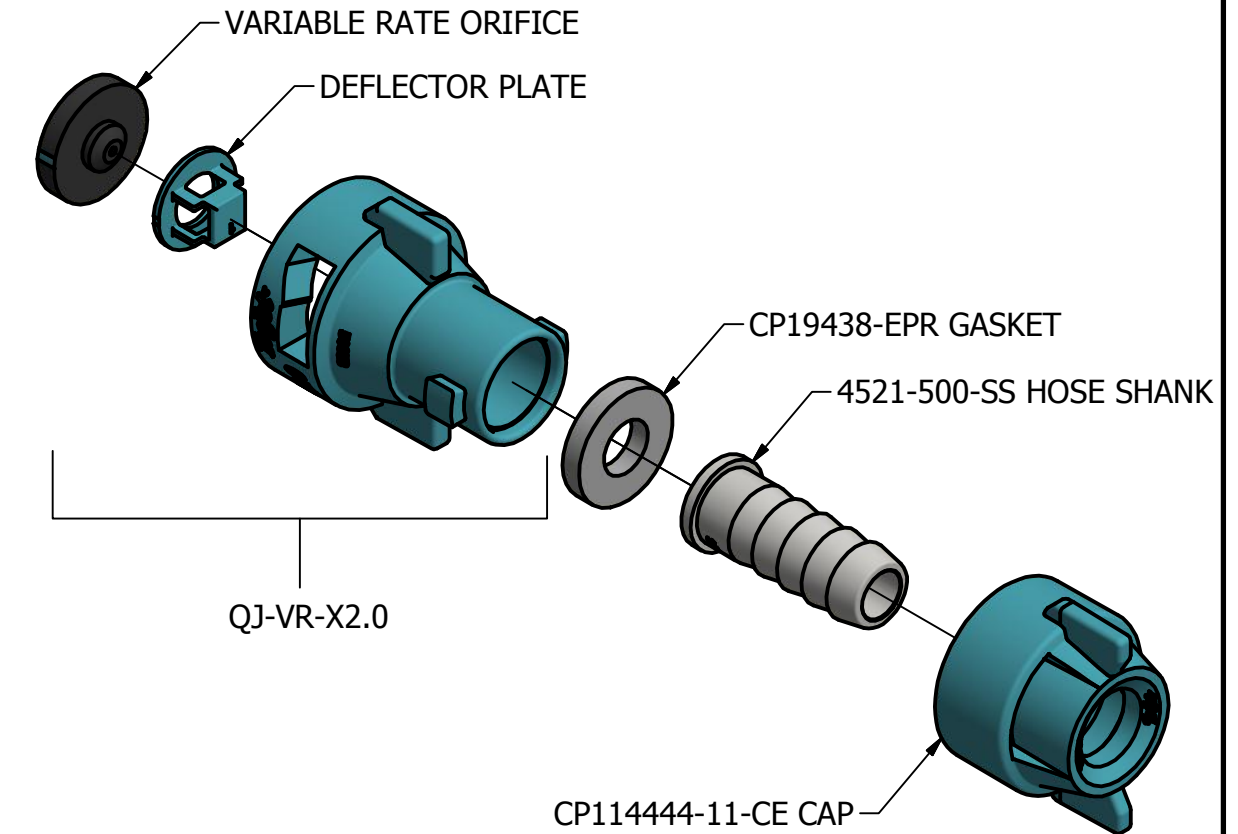
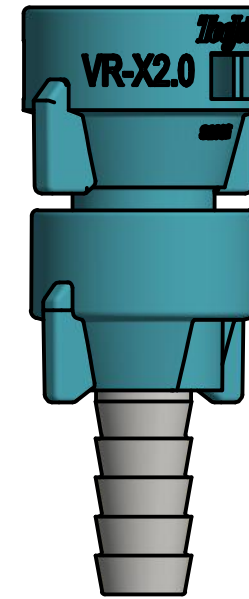

QJ-VR-X2.0 VARIABLE RATE HOSE BARB FERTILIZER NOZZLE										
TIP NO. (STRAINER MESH SIZE)	LIQUID PRESSURE IN PSI	CAPACITY 1 NOZZLE IN GPM	30" SPACING							
			GALLONS PER ACRE							
			4 MPH	5 MPH	6 MPH	8 MPH	10 MPH	12 MPH	16 MPH	20 MPH
QJ-VR-X2.0 (50)	10	0.38	18.8	15.0	12.5	9.4	7.5	6.3	4.7	3.8
	20	0.57	28	23	18.8	14.1	11.3	9.4	7.1	5.6
	30	0.73	36	29	24	18.1	14.5	12.0	9.0	7.2
	40	0.87	43	34	29	22	17.2	14.4	10.8	8.6
	50	1.03	51	41	34	25	20	17.0	12.7	10.2
	60	1.20	59	48	40	30	24	19.8	14.9	11.9
	70	1.40	69	55	46	35	28	23	17.3	13.9
	80	1.61	80	64	53	40	32	27	19.9	15.9
	90	1.84	91	73	61	46	36	30	23	18.2
	100	2.07	102	82	68	51	41	34	26	20

- * APPLICATION DATA IS BASED ON SPRAYING WATER AT 70 DEG F (21 DEG C).
- * FLOW RATES ARE MEASURED AVERAGES BETWEEN 3/8" & 1/2" VERSIONS.
- * DEFLECTOR PLATE REQUIRED TO MAINTAIN PUBLISHED FLOW RATES AND STEADY STREAM.

HOW TO ORDER:

QJ-VR-X2.0-3/8-SS - VARIABLE RATE FERTILIZER ASSEMBLY WITH STAINLESS STEEL 3/8" HOSE BARB
 QJ-VR-X2.0-1/2-NYB - VARIABLE RATE FERTILIZER ASSEMBLY WITH NYLON 1/2" HOSE BARB

FERTILIZER SPECIFIC GRAVITY CONVERSION FACTORS:

WEIGHT OF SOLUTION	SPECIFIC GRAVITY	CONVERSION FACTOR
7.0 LBS./GAL.	0.84	0.92
8.0 LBS./GAL.	0.96	0.98
8.34 LBS./GAL.	1.00-WATER	1.00
9.0 LBS./GAL.	1.08	1.04
10.0 LBS./GAL.	1.20	1.10
10.65 LBS./GAL.	1.28-28% NITROGEN	1.13
11.0 LBS./GAL.	1.32	1.15
12.0 LBS./GAL.	1.44	1.20
14.0 LBS./GAL.	1.68	1.30

NOTE: CONVERSION FACTORS MUST BE USED WHEN SPRAYING SOLUTIONS HEAVIER OR LIGHTER THAN WATER. FIRST, MULTIPLY DESIRED APPLICATION RATE BY THE APPROPRIATE CONVERSION FACTOR ABOVE. THEN USE THE NEW APPLICATION RATE TO SELECT THE MOST APPROPRIATE OPERATING PRESSURE FROM THE APPLICATION CHART ON THIS PAGE.

DESCRIPTION: APPLICATION RATES FOR QJ-VR-X2.0-3/8 & QJ-VR-X2.0-1/2 VARIABLE RATE HOSE BARB FERTILIZER ASSEMBLY		
	REVISION NO. 1	DATASHEET DSQJ-VR-X2.0
	REFERENCE: 5/10/2017	SHEET: DWG SIZE: B