

QJ-VR-X0.5 VARIABLE RATE HOSE BARB FERTILIZER ASSEMBLY

FEATURES:

- DESIGNED FOR USE IN FLOWMETER-BASED APPLICATION SYSTEMS
- AVAILABLE FOR 1/4", 5/16" & 3/8" I.D. HOSE
- 1/4" & 5/16" VERSION HOSE BARBS AVAILABLE IN STAINLESS STEEL; 3/8" VERSION HOSE BARB AVAILABLE IN STAINLESS STEEL AND NYLON
- REMOVABLE VARIABLE RATE ORIFICE (EPDM) FOR EASY CLEANING
- VARIABLE RATE FOR A WIDE RANGE OF APPLICATION SPEEDS AND RATES
- NYLON, ACETAL & EPDM CONSTRUCTION FOR EXCELLENT CHEMICAL RESISTANCE
- RECOMMENDED OPERATING PRESSURE: 10 - 100 PSI (1.0 - 7.0 BAR)

TYPICAL APPLICATIONS:

- EXCELLENT FOR VARIABLE RATE APPLICATION OF LIQUID FERTILIZER
- EXCELLENT FOR MAINTAINING A FIXED RATE OVER A WIDE RANGE OF SPEEDS

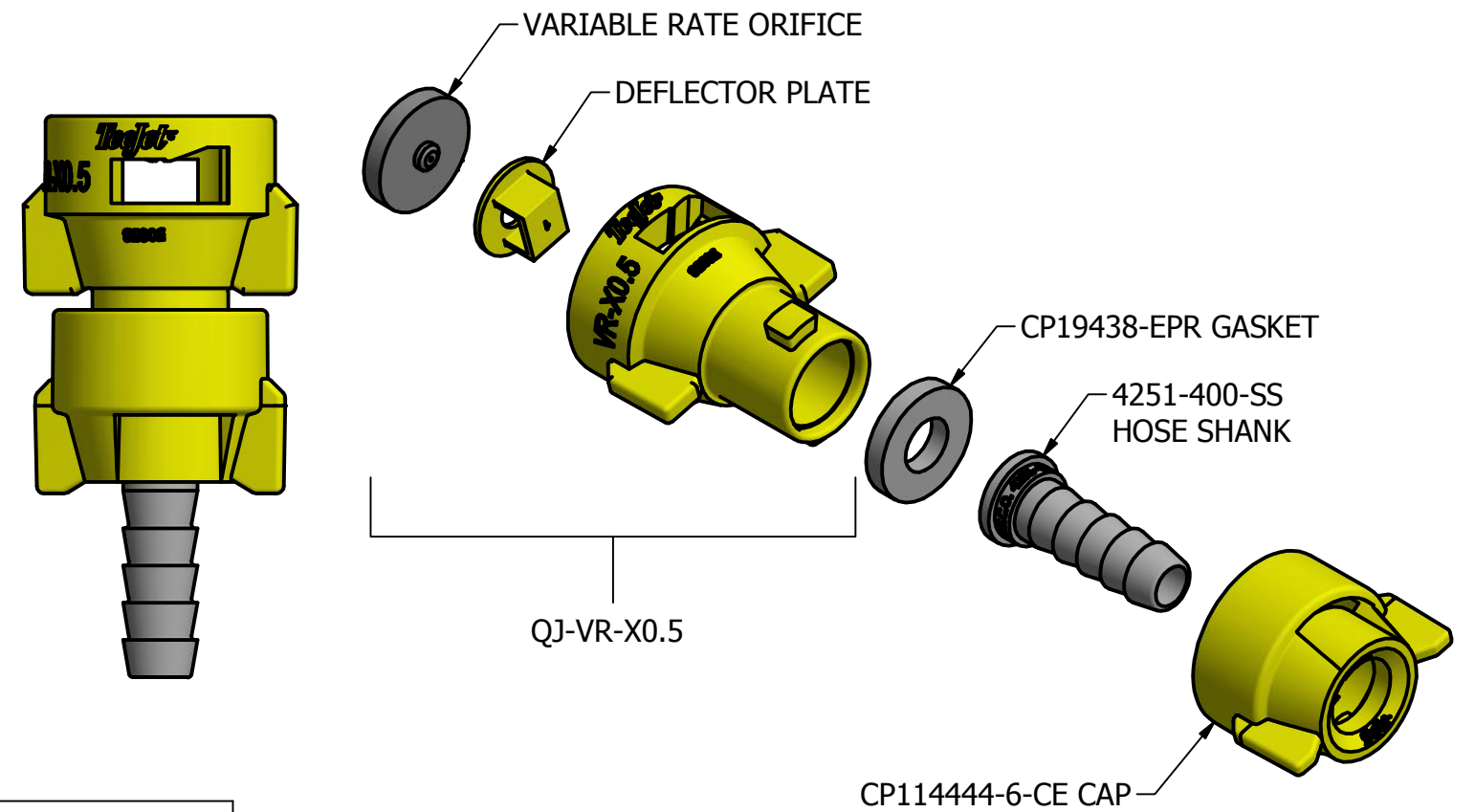

| QJ-VR-X0.5 VARIABLE RATE HOSE BARB FERTILIZER NOZZLE | | | | | | | | | | |
|--|------------------------------|--------------------------------|------------------|-------|-------|-------|--------|--------|--------|--------|
| TIP NO. (STRAINER MESH SIZE) | LIQUID PRESSURE IN PSI | CAPACITY 1 NOZZLE IN GPM | 30" SPACING | | | | | | | |
| | | | GALLONS PER ACRE | | | | | | | |
| | | | 4 MPH | 5 MPH | 6 MPH | 8 MPH | 10 MPH | 12 MPH | 16 MPH | 20 MPH |
| QJ-VR-X0.5 (50) | 10 | 0.09 | 4.5 | 3.6 | 3.0 | 2.2 | 1.8 | 1.5 | 1.1 | 0.9 |
| | 20 | 0.13 | 6.4 | 5.1 | 4.3 | 3.2 | 2.6 | 2.1 | 1.6 | 1.3 |
| | 30 | 0.17 | 8.4 | 6.7 | 5.6 | 4.2 | 3.4 | 2.8 | 2.1 | 1.7 |
| | 40 | 0.21 | 10.4 | 8.3 | 6.9 | 5.2 | 4.2 | 3.5 | 2.6 | 2.1 |
| | 50 | 0.24 | 11.9 | 9.5 | 7.9 | 5.9 | 4.8 | 4.0 | 3.0 | 2.4 |
| | 60 | 0.29 | 14.4 | 11.5 | 9.6 | 7.2 | 5.7 | 4.8 | 3.6 | 2.9 |
| | 70 | 0.34 | 16.8 | 13.5 | 11.2 | 8.4 | 6.7 | 5.6 | 4.2 | 3.4 |
| | 80 | 0.40 | 19.8 | 15.8 | 13.2 | 9.9 | 7.9 | 6.6 | 5.0 | 4.0 |
| | 90 | 0.46 | 23 | 18.2 | 15.2 | 11.4 | 9.1 | 7.6 | 5.7 | 4.6 |
| | 100 | 0.54 | 27 | 21 | 17.8 | 13.4 | 10.7 | 8.9 | 6.7 | 5.3 |

- * APPLICATION DATA IS BASED ON SPRAYING WATER AT 70 DEG F (21 DEG C).
- * FLOW RATES ARE MEASURED AVERAGES BETWEEN 1/4", 5/16" & 3/8" VERSIONS.
- * DEFLECTOR PLATE REQUIRED TO MAINTAIN PUBLISHED FLOW RATES AND STEADY STREAM.

HOW TO ORDER:

QJ-VR-X0.5-1/4-SS - VARIABLE RATE FERTILIZER ASSEMBLY WITH STAINLESS STEEL 1/4" HOSE BARB
 QJ-VR-X0.5-3/8-NYB - VARIABLE RATE FERTILIZER ASSEMBLY WITH NYLON 3/8" HOSE BARB

FERTILIZER SPECIFIC GRAVITY CONVERSION FACTORS:

| WEIGHT OF SOLUTION | SPECIFIC GRAVITY | CONVERSION FACTOR |
|--------------------|-------------------|-------------------|
| 7.0 LBS./GAL. | 0.84 | 0.92 |
| 8.0 LBS./GAL. | 0.96 | 0.98 |
| 8.34 LBS./GAL. | 1.00-WATER | 1.00 |
| 9.0 LBS./GAL. | 1.08 | 1.04 |
| 10.0 LBS./GAL. | 1.20 | 1.10 |
| 10.65 LBS./GAL. | 1.28-28% NITROGEN | 1.13 |
| 11.0 LBS./GAL. | 1.32 | 1.15 |
| 12.0 LBS./GAL. | 1.44 | 1.20 |
| 14.0 LBS./GAL. | 1.68 | 1.30 |

NOTE: CONVERSION FACTORS MUST BE USED WHEN SPRAYING SOLUTIONS HEAVIER OR LIGHTER THAN WATER. FIRST, MULTIPLY DESIRED APPLICATION RATE BY THE APPROPRIATE CONVERSION FACTOR ABOVE. THEN USE THE NEW APPLICATION RATE TO SELECT THE MOST APPROPRIATE OPERATING PRESSURE FROM THE APPLICATION CHART ON THIS PAGE.

| | | |
|---|----------------------|---------------------------|
| DESCRIPTION: APPLICATION RATES FOR QJ-VR-X0.5-1/4, QJ-VR-X0.5-5/16 & QJ-VR-X0.5-3/8 VARIABLE RATE HOSE BARB FERTILIZER ASSEMBLY | | |
| | REVISION NO. 1 | DATASHEET DSQJ-VR-X0.5 |
| | REFERENCE: 9/7/17 | SHEET: DWG SIZE: B |