

Turbo TeeJet®

FEATURES:

- TAPERED EDGE WIDE ANGLE FLAT PATTERN FOR UNIFORM COVERAGE IN BROADCAST SPRAYING.
- LARGE, ROUND FREE PASSAGE TO MINIMIZE CLOGGING.
- DROPLET SIZE RANGE SUITABLE FOR AN EXCELLENT BALANCE OF TARGET COVERAGE AND DRIFT MANAGEMENT.
- SUGGESTED SPRAY PRESSURE RANGE: 15-90 PSI.
- EXCELLENT RESISTANCE TO CORROSIVE SOLUTIONS.
- SUPERIOR WEAR CHARACTERISTICS.
- AUTOMATIC SPRAY ALIGNMENT WITH 25612-_-NYR QUICK TEEJET® CAP AND GASKET FOR CAPACITIES 01 THRU 08; 114502-_-CELR FOR CAPACITIES 10 & 12.

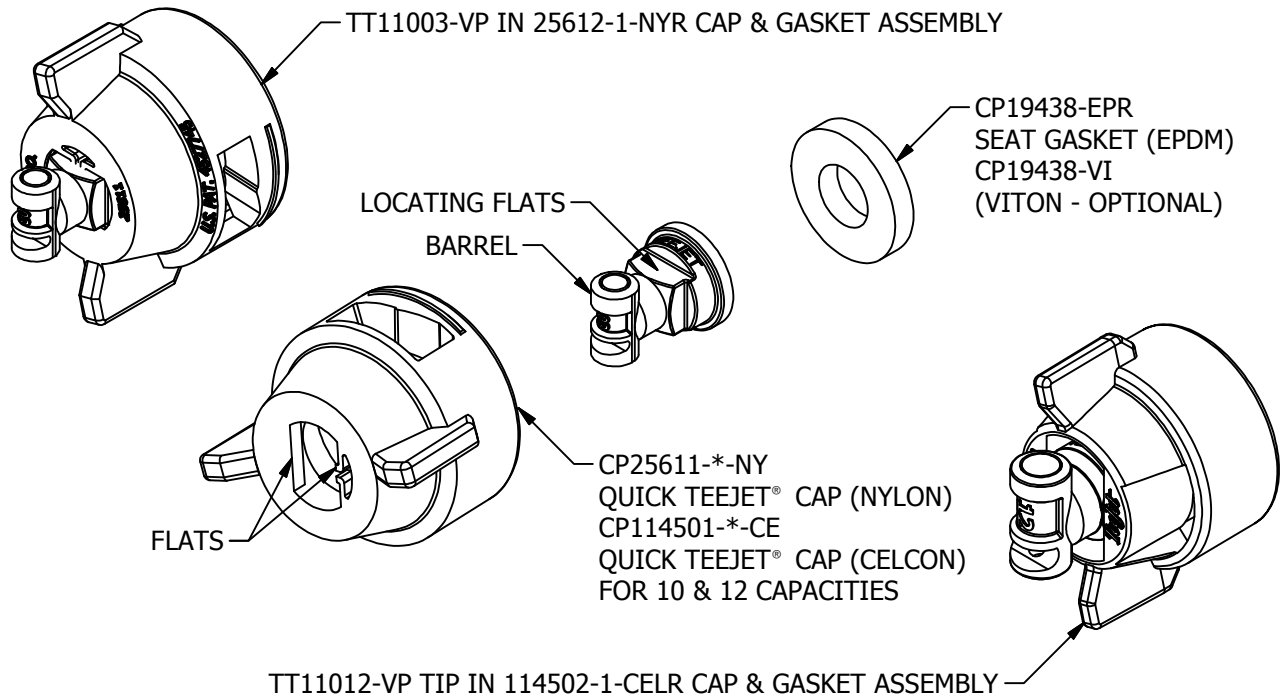
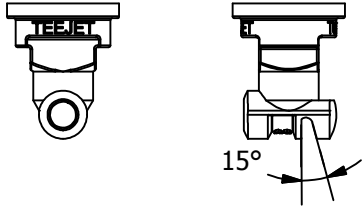

TIP INSTALLATION:

1. ALIGN BARREL WITH CAP FLATS AND PRESS IN TIP UNTIL THE TIP BOTTOMS OUT.
2. ROTATE TIP 90° UNTIL LOCATING FLATS ARE PARALLEL TO CAP FLATS, PRESS TIP UNTIL TIP BOTTOMS OUT AGAIN.

DROPLET SIZE CATEGORIES					
F	M	C	VC	XC	UC
FINE	MEDIUM	COARSE	VERY COARSE	EXTREMELY COARSE	ULTRA COARSE

OPTIMUM SPRAY HEIGHT	
20" SPACING	30" SPACING
20"	30"

DROPLET SIZE CLASSIFICATIONS ARE BASED ON BCPC SPECIFICATIONS AND IN ACCORDANCE WITH ASABE STANDARD S-572.1 OF THE DATE OF PRINTING. CLASSIFICATIONS ARE SUBJECT TO CHANGE.

DESCRIPTION:

GALLON PER ACRE
TABULATION FOR
TT110_-VP TURBO TEEJET®
POLYMER FLAT SPRAY TIP

TeeJet®
TECHNOLOGIES

REVISION NO.	2	DATASHEET	
REFERENCE:	6/27/2016	DS38588	
SHEET:	1 OF 3	DWG SIZE:	A

TIP COLOR VISIFLO	TIP No. STRAINER MESH SIZE	LIQUID PRESSURE (PSI)	DROPLET SIZE	CAPACITY ONE NOZZLE (GPM)	CAPACITY ONE NOZZLE (oz./min)	GALLONS PER ACRE 20" NOZZLE SPACING								GALLONS PER 1000 Sq. Ft. 20" NOZZLE SPACING			
						4	5	6	8	10	12	15	20	2	3	4	5
						MPH	MPH	MPH	MPH	MPH	MPH	MPH	MPH	MPH	MPH	MPH	MPH
ORANGE	11001-VP (100 MESH)	15	C	0.061	7.8	4.5	3.6	3.0	2.3	1.8	1.5	1.2	0.9	0.21	0.14	0.10	0.08
		20	C	0.071	9.1	5.3	4.2	3.5	2.6	2.1	1.8	1.4	1.1	0.24	0.16	0.12	0.10
		30	M	0.087	11	6.5	5.2	4.3	3.2	2.6	2.2	1.7	1.3	0.30	0.20	0.15	0.12
		40	M	0.10	13	7.4	5.9	5.0	3.7	3.0	2.5	2.0	1.5	0.34	0.23	0.17	0.14
		50	M	0.11	14	8.2	6.5	5.4	4.1	3.3	2.7	2.2	1.6	0.37	0.25	0.19	0.15
		60	F	0.12	15	8.9	7.1	5.9	4.5	3.6	3.0	2.4	1.8	0.41	0.27	0.20	0.16
		70	F	0.13	17	9.7	7.7	6.4	4.8	3.9	3.2	2.6	1.9	0.44	0.29	0.22	0.18
		80	F	0.14	18	10.4	8.3	6.9	5.2	4.2	3.5	2.8	2.1	0.48	0.32	0.24	0.19
		90	F	0.15	19	11.1	8.9	7.4	5.6	4.5	3.7	3.0	2.2	0.51	0.34	0.26	0.20
GREEN	110015-VP (100 MESH)	15	VC	0.092	12	6.8	5.5	4.6	3.4	2.7	2.3	1.8	1.4	0.31	0.21	0.16	0.13
		20	C	0.11	14	8.2	6.5	5.4	4.1	3.3	2.7	2.2	1.6	0.37	0.25	0.19	0.15
		30	M	0.13	17	9.7	7.7	6.4	4.8	3.9	3.2	2.6	1.9	0.44	0.29	0.22	0.18
		40	M	0.15	19	11.1	8.9	7.4	5.6	4.5	3.7	3.0	2.2	0.51	0.34	0.26	0.20
		50	M	0.17	22	12.6	10.1	8.4	6.3	5.0	4.2	3.4	2.5	0.58	0.39	0.29	0.23
		60	F	0.18	23	13.4	10.7	8.9	6.7	5.3	4.5	3.6	2.7	0.61	0.41	0.31	0.24
		70	F	0.20	26	14.9	11.9	9.9	7.4	5.9	5.0	4.0	3.0	0.68	0.45	0.34	0.27
		80	F	0.21	27	15.6	12.5	10.4	7.8	6.2	5.2	4.2	3.1	0.71	0.48	0.36	0.29
		90	F	0.23	29	17.1	13.7	11.4	8.5	6.8	5.7	4.6	3.4	0.78	0.52	0.39	0.31
YELLOW	11002-VP (50 MESH)	15	VC	0.12	15	8.9	7.1	5.9	4.5	3.6	3.0	2.4	1.8	0.41	0.27	0.20	0.16
		20	VC	0.14	18	10.4	8.3	6.9	5.2	4.2	3.5	2.8	2.1	0.48	0.32	0.24	0.19
		30	C	0.17	22	12.6	10.1	8.4	6.3	5.0	4.2	3.4	2.5	0.58	0.39	0.29	0.23
		40	M	0.20	26	14.9	11.9	9.9	7.4	5.9	5.0	4.0	3.0	0.68	0.45	0.34	0.27
		50	M	0.22	28	16.3	13.1	10.9	8.2	6.5	5.4	4.4	3.3	0.75	0.50	0.37	0.30
		60	M	0.24	31	17.8	14.3	11.9	8.9	7.1	5.9	4.8	3.6	0.82	0.54	0.41	0.33
		70	F	0.26	33	19.3	15.4	12.9	9.7	7.7	6.4	5.1	3.9	0.88	0.59	0.44	0.35
		80	F	0.28	36	21	16.6	13.9	10.4	8.3	6.9	5.5	4.2	0.95	0.63	0.48	0.38
		90	F	0.30	38	22	17.8	14.9	11.1	8.9	7.4	5.9	4.5	1.0	0.68	0.51	0.41
VIOLET	110025-VP (50 MESH)	15	VC	0.15	19	11.1	8.9	7.4	5.6	4.5	3.7	3.0	2.2	0.51	0.34	0.26	0.20
		20	VC	0.18	23	13.4	10.7	8.9	6.7	5.3	4.5	3.6	2.7	0.61	0.41	0.31	0.24
		30	C	0.22	28	16.3	13.1	10.9	8.2	6.5	5.4	4.4	3.3	0.75	0.50	0.37	0.30
		40	M	0.25	32	18.6	14.9	12.4	9.3	7.4	6.2	5.0	3.7	0.85	0.57	0.43	0.34
		50	M	0.28	36	21	16.6	13.9	10.4	8.3	6.9	5.5	4.2	0.95	0.63	0.48	0.38
		60	M	0.31	40	23	18.4	15.3	11.5	9.2	7.7	6.1	4.6	1.1	0.70	0.53	0.42
		70	F	0.33	42	25	19.6	16.3	12.3	9.8	8.2	6.5	4.9	1.1	0.75	0.56	0.45
		80	F	0.35	45	26	21	17.3	13.0	10.4	8.7	6.9	5.2	1.2	0.79	0.60	0.48
		90	F	0.38	49	28	23	18.8	14.1	11.3	9.4	7.5	5.6	1.3	0.86	0.65	0.52
BLUE	11003-VP (50 MESH)	15	VC	0.18	23	13.4	10.7	8.9	6.7	5.3	4.5	3.6	2.7	0.61	0.41	0.31	0.24
		20	VC	0.21	27	15.6	12.5	10.4	7.8	6.2	5.2	4.2	3.1	0.71	0.48	0.36	0.29
		30	C	0.26	33	19.3	15.4	12.9	9.7	7.7	6.4	5.1	3.9	0.88	0.59	0.44	0.35
		40	C	0.30	38	22	17.8	14.9	11.1	8.9	7.4	5.9	4.5	1.0	0.68	0.51	0.41
		50	M	0.34	44	25	20	16.8	12.6	10.1	8.4	6.7	5.0	1.2	0.77	0.58	0.46
		60	M	0.37	47	27	22	18.3	13.7	11.0	9.2	7.3	5.5	1.3	0.84	0.63	0.50
		70	M	0.40	51	30	24	19.8	14.9	11.9	9.9	7.9	5.9	1.4	0.91	0.68	0.54
		80	M	0.42	54	31	25	21	15.6	12.5	10.4	8.3	6.2	1.4	0.95	0.71	0.57
		90	F	0.45	58	33	27	22	16.7	13.4	11.1	8.9	6.7	1.5	1.0	0.77	0.61
RED	11004-VP (50 MESH)	15	XC	0.24	31	17.8	14.3	11.9	8.9	7.1	5.9	4.8	3.6	0.82	0.54	0.41	0.33
		20	VC	0.28	36	21	16.6	13.9	10.4	8.3	6.9	5.5	4.2	0.95	0.63	0.48	0.38
		30	C	0.35	45	26	21	17.3	13.0	10.4	8.7	6.9	5.2	1.2	0.79	0.60	0.48
		40	C	0.40	51	30	24	19.8	14.9	11.9	9.9	7.9	5.9	1.4	0.91	0.68	0.54
		50	M	0.45	58	33	27	22	16.7	13.4	11.1	8.9	6.7	1.5	1.0	0.77	0.61
		60	M	0.49	63	36	29	24	18.2	14.6	12.1	9.7	7.3	1.7	1.1	0.83	0.67
		70	M	0.53	68	39	31	26	19.7	15.7	13.1	10.5	7.9	1.8	1.2	0.90	0.72
		80	M	0.57	73	42	34	28	21	16.9	14.1	11.3	8.5	1.9	1.3	0.97	0.78
		90	M	0.60	77	45	36	30	22	17.8	14.9	11.9	8.9	2.0	1.4	1.0	0.82
BROWN	11005-VP (50 MESH)	15	XC	0.31	40	23	18.4	15.3	11.5	9.2	7.7	6.1	4.6	1.1	0.70	0.53	0.42
		20	VC	0.35	45	26	21	17.3	13.0	10.4	8.7	6.9	5.2	1.2	0.79	0.60	0.48
		30	VC	0.43	55	32	26	21	16.0	12.8	10.6	8.5	6.4	1.5	0.97	0.73	0.58
		40	C	0.50	64	37	30	25	18.6	14.9	12.4	9.9	7.4	1.7	1.1	0.85	0.68
		50	C	0.56	72	42	33	28	21	16.6	13.9	11.1	8.3	1.9	1.3	0.95	0.76
		60	M	0.61	78	45	36	30	23	18.1	15.1	12.1	9.1	2.1	1.4	1.0	0.83
		70	M	0.66	84	49	39	33	25	19.6	16.3	13.1	9.8	2.2	1.5	1.1	0.90
		80	M	0.71	91	53	42	35	26	21	17.6	14.1	10.5	2.4	1.6	1.2	0.97
		90	M	0.75	96	56	45	37	28	22	18.6	14.9	11.1	2.6	1.7	1.3	1.0

DESCRIPTION:
**GALLON PER ACRE
TABULATION FOR
TT110_-VP TURBO TEEJET®
POLYMER FLAT SPRAY TIP**



REVISION NO.	2	DATASHEET	
REFERENCE:	6/27/2016	DS38588	
SHEET:	2 OF 3	DWG SIZE:	A

TIP COLOR VISIFLO	TIP No. STRAINER MESH SIZE	LIQUID PRESSURE (PSI)	DROPLET SIZE	CAPACITY ONE NOZZLE (GPM)	CAPACITY ONE NOZZLE (oz./min)	GALLONS PER ACRE 20" NOZZLE SPACING								GALLONS PER 1000 Sq. Ft. 20" NOZZLE SPACING			
						4 MPH	5 MPH	6 MPH	8 MPH	10 MPH	12 MPH	15 MPH	20 MPH	2 MPH	3 MPH	4 MPH	5 MPH
GRAY	11006-VP (50 MESH)	15	XC	0.37	47	27	22	18.3	13.7	11.0	9.2	7.3	5.5	1.3	0.84	0.63	0.50
		20	VC	0.42	54	31	25	21	15.6	12.5	10.4	8.3	6.2	1.4	0.95	0.71	0.57
		30	VC	0.52	67	39	31	26	19.3	15.4	12.9	10.3	7.7	1.8	1.2	0.88	0.71
		40	C	0.60	77	45	36	30	22	17.8	14.9	11.9	8.9	2.0	1.4	1.0	0.82
		50	C	0.67	86	50	40	33	25	19.9	16.6	13.3	9.9	2.3	1.5	1.1	0.91
		60	C	0.73	93	54	43	36	27	22	18.1	14.5	10.8	2.5	1.7	1.2	0.99
		70	C	0.79	101	59	47	39	29	23	19.6	15.6	11.7	2.7	1.8	1.3	1.1
		80	M	0.85	109	63	50	42	32	25	21	16.8	12.6	2.9	1.9	1.5	1.2
		90	M	0.90	115	67	53	45	33	27	22	17.8	13.4	3.1	2.0	1.5	1.2
WHITE	11008-VP (50 MESH)	15	XC	0.49	63	36	29	24	18.2	14.6	12.1	9.7	7.3	1.7	1.1	0.83	0.67
		20	VC	0.57	73	42	34	28	21	16.9	14.1	11.3	8.5	1.9	1.3	0.97	0.78
		30	VC	0.69	88	51	41	34	26	20	17.1	13.7	10.2	2.3	1.6	1.2	0.94
		40	C	0.80	102	59	48	40	30	24	19.8	15.8	11.9	2.7	1.8	1.4	1.1
		50	C	0.89	114	66	53	44	33	26	22	17.6	13.2	3.0	2.0	1.5	1.2
		60	C	0.98	125	73	58	49	36	29	24	19.4	14.6	3.3	2.2	1.7	1.3
		70	C	1.06	136	79	63	52	39	31	26	21	15.7	3.6	2.4	1.8	1.4
		80	M	1.13	145	84	67	56	42	34	28	22	16.8	3.8	2.6	1.9	1.5
		90	M	1.20	154	89	71	59	45	36	30	24	17.8	4.1	2.7	2.0	1.6
LIGHT BLUE	11010-VP	15	UC	0.61	78	45	36	30	23	18.1	15.1	12.1	9.1	2.1	1.4	1.0	0.83
		20	XC	0.71	91	53	42	35	26	21	17.6	14.1	10.5	2.4	1.6	1.2	0.97
		30	VC	0.87	111	65	52	43	32	26	22	17.2	12.9	3.0	2.0	1.5	1.2
		40	VC	1.00	128	74	59	50	37	30	25	19.8	14.9	3.4	2.3	1.7	1.4
		50	C	1.12	143	83	67	55	42	33	28	22	16.6	3.8	2.5	1.9	1.5
		60	C	1.22	156	91	72	60	45	36	30	24	18.1	4.2	2.8	2.1	1.7
		70	C	1.32	169	98	78	65	49	39	33	26	19.6	4.5	3.0	2.2	1.8
		80	C	1.41	180	105	84	70	52	42	35	28	21	4.8	3.2	2.4	1.9
		90	M	1.50	192	111	89	74	56	45	37	30	22	5.1	3.4	2.6	2.0
TELE- MAGENTA	11012-VP	15	UC	0.73	93	54	43	36	27	22	18.1	14.5	10.8	2.5	1.7	1.2	0.99
		20	UC	0.85	109	63	50	42	32	25	21	16.8	12.6	2.9	1.9	1.5	1.2
		30	XC	1.04	133	77	62	51	39	31	26	21	15.4	3.5	2.4	1.8	1.4
		40	VC	1.20	154	89	71	59	45	36	30	24	17.8	4.1	2.7	2.0	1.6
		50	VC	1.34	172	99	80	66	50	40	33	27	19.9	4.6	3.0	2.3	1.8
		60	C	1.47	188	109	87	73	55	44	36	29	22	5.0	3.3	2.5	2.0
		70	C	1.59	204	118	94	79	59	47	39	31	24	5.4	3.6	2.7	2.2
		80	C	1.70	218	126	101	84	63	50	42	34	25	5.8	3.9	2.9	2.3
		90	C	1.80	230	134	107	89	67	53	45	36	27	6.1	4.1	3.1	2.5

DESCRIPTION:
**GALLON PER ACRE
TABULATION FOR
TT110_-VP TURBO TEEJET®
POLYMER FLAT SPRAY TIP**



REVISION NO.	2	DATASHEET	
REFERENCE:	6/27/2016	DS38588	
SHEET:	3 OF 3	DWG SIZE:	A