

EXAMPLE PART #: QJS-D-1-CM-3-EEE  
 NOTE: 2 OUTLETS ARRANGED PERPENDICULAR TO BOOM;  
 3 OUTLETS PARALLEL TO BOOM.

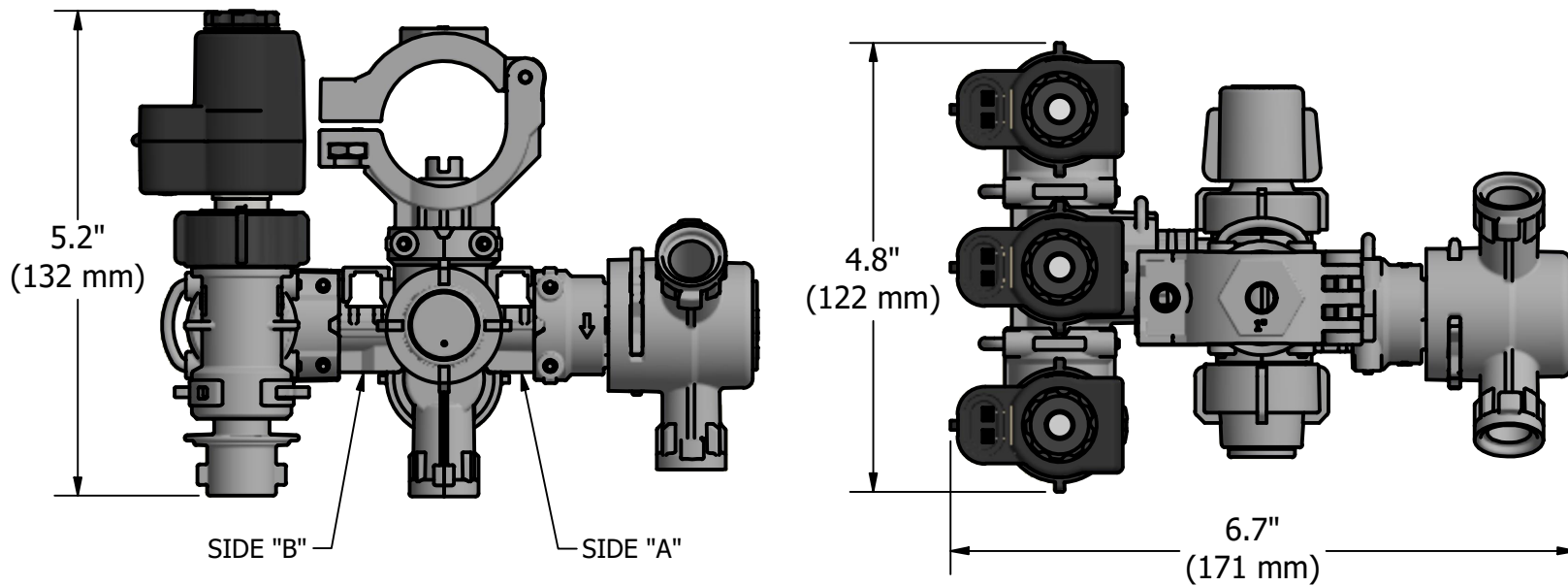

NOTE: ALL DIMENSIONS ARE APPROXIMATE

**TEEJET CHEMSAVER® OPTIONS:**

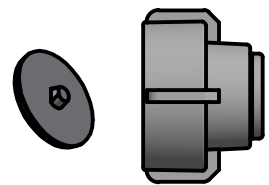

TEEJET DIAPHRAGM CHEMSAVER  
 PART NO. 58577  
 DIAPHRAGM: CP56709-VI

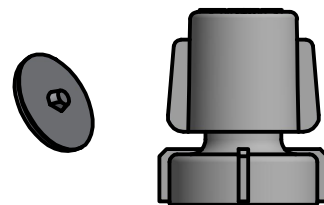

TEEJET MANUAL CHEMSAVER  
 PART NO. 58140-NYB  
 DIAPHRAGM: CP56709-VI

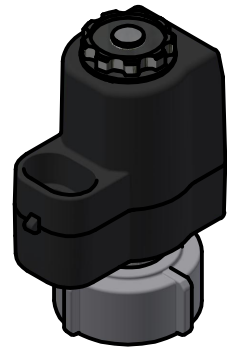

TEEJET e-CHEMSAVER  
 PART NO. 115880-4-12 or 115880-4-24  
 SPECIAL GASKET: CP58589-VI

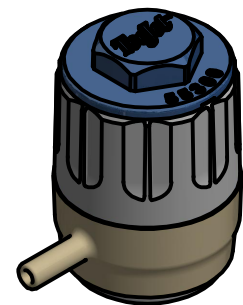

TEEJET AIR CHEMSAVER  
 PART NO. 55300  
 SPECIAL GASKET: CP58589-VI

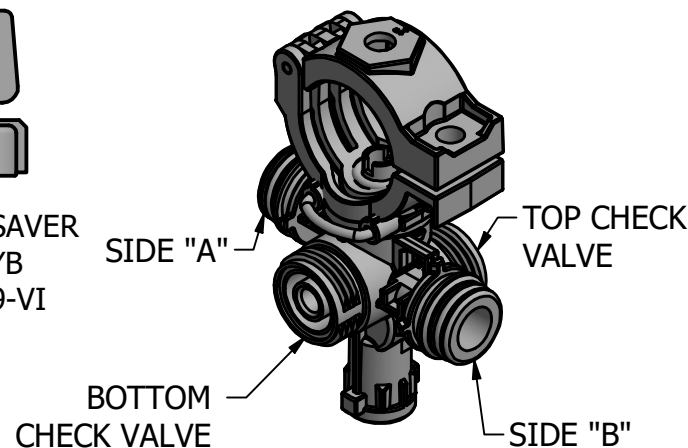

**QJS- D STACKABLE NOZZLE BODY**

- \* 3 OR 5 SPRAY POSITION TURRET AVAILABLE.
- \* UP TO 3 STACKED OUTLETS ON EACH SIDE.
- \* BOTTOM OUTLET CONTROLLED BY DEDICATED CHECK VALVE.
- \* MADE OF CORROSION RESISTANT MATERIALS.
- \* ATTACHES TO BOOM WITH M6-25mm STAINLESS STEEL PHILLIPS SCREW, AND M6x1mm NUT WHICH IS FIXED INTO LOWER BODY CLAMP.
- \* STANDARD O-RINGS MADE OF VITON®.
- \* MAXIMUM OPERATING PRESSURE 300 PSI (20.7 BAR).
- \* MAXIMUM FLOW RATING 2.75 GPM (10.4 L/MIN) AT 5 PSI (0.34 BAR) PRESSURE DROP AND 4.0 GPM (15.1 L/MIN) AT 10 PSI (0.7 BAR) PRESSURE DROP PER OUTLET.
- \* FEATURES QUICK TEEJET CAP CONNECTION.
- \* CAN BE EQUIPPED WITH MOST TEEJET CHEMSAVER® OPTIONS.  
 NOTE: FLOW RATES THROUGH DIFFERENT CHEMSAVER® OPTIONS CAN BE FOUND ON THEIR CORRESPONDING DATA SHEETS.
- \* MATERIALS: WETTED PARTS ARE NYLON AND VITON®.  
 NOTE: DIFFERENT CHEMSAVER OPTIONS INCLUDE EPDM, KYNAR®, NYLON AND VITON®.
- \* WET BOOM SIZES: 20mm, 25mm, AND 28mm TUBING; 1/2", 3/4", AND 1" PIPE.
- \* 8MM HEX SOCKET ON UPPER CLAMP STANDARD; 6MM AVAILABLE.
- \* FOR "HOW TO ORDER" INSTRUCTIONS PLEASE SEE DATA SHEET DS58585-1.

**INSTALLATION NOTE:**

- \* PLACE SCREW IN NUT AND BEGIN TURNING BY HAND (1-2 TURNS) TO ENSURE PROPER ENGAGEMENT BEFORE USING A LOW SPEED TORQUE GUN.
- \* TORQUE TO 20-23 IN-LBS.

KYNAR® IS A REGISTERED TRADEMARK OF ARKEMA, INC.  
 VITON® IS A REGISTERED TRADEMARK OF THE CHEMOURS COMPANY.

DESCRIPTION:			
QJS-D STACKABLE QUICK TEEJET® NOZZLE BODY ASSEMBLY			
REVISION NO.	2	DATA SHEET	
REFERENCE:	10/14/24	<b>DS116884-D</b>	
		SHEET:	1 OF 1
		DWG SIZE:	B