

NOZZLE DESCRIPTION				LIQUID PRESSURE IN PSI	CAPACITY IN GPM	"H"	"W"	GALLONS PER ACRE					
NOZZLE No.	HEX.	ORIFICE DIA.	"L"					2 MPH	3 MPH	4 MPH	5 MPH	7.5 MPH	10 MPH
3/4KLC50	1-1/4"	.234	2.69"	10	5.0	18"	16'	77	52	39	31	21	15.5
				20	7.1	19'	92	62	46	37	25	18.5	
				30	8.7	22'	98	65	49	39	26	19.5	
				40	10.0	23'	108	72	54	43	29	22	
				10	5.0	24"	17'	73	49	36	29	19.4	14.6
				20	7.1	20'	88	58	44	35	23	17.5	
				30	8.7	23'	93	62	47	37	25	18.7	
				40	10.0	25'	99	66	50	40	26	19.8	
				10	5.0	30"	19'	65	43	33	26	17.4	13.0
				20	7.1	21'	83	56	42	33	22	16.7	
				30	8.7	25'	86	57	43	34	23	17.2	
				40	10.0	27'	92	61	46	37	25	18.4	
3/4KLC72	1-1/4"	.281	2.69"	10	5.0	36"	20'	62	41	31	25	16.5	12.4
				20	7.1	23'	76	51	38	30	20	15.2	
				30	8.7	26'	82	55	41	33	22	16.5	
				40	10.0	28'	88	59	44	35	24	17.7	
				10	7.2	18"	17'	105	70	53	42	28	21
				20	10.2	21'	120	80	60	48	32	24	
				30	12.5	23'	135	90	67	54	36	27	
				40	14.4	25'	143	95	71	57	38	29	
				10	7.2	24"	18'	99	66	50	40	26	19.8
				20	10.2	22'	115	77	57	46	31	23	
				30	12.5	25'	124	83	62	50	33	25	
				40	14.4	27'	132	88	66	53	35	26	
3/4KLC108	1-1/4"	.344	2.88"	10	7.2	30"	19'	94	63	47	38	25	18.8
				20	10.2	23'	110	73	55	44	29	22	
				30	12.5	27'	115	77	57	46	31	23	
				40	14.4	29'	123	82	62	49	33	25	
				10	7.2	36"	21'	85	57	42	34	23	17.0
				20	10.2	25'	101	67	51	40	27	20	
				30	12.5	29'	107	71	53	43	29	21	
				40	14.4	31'	115	77	58	46	31	23	
				10	10.8	18"	19'	141	94	70	56	38	28
				20	15.2	24'	157	105	79	63	42	31	
				30	18.7	27'	172	115	86	69	46	34	
				40	21.6	30'	179	119	89	71	48	36	
3/4KLC108	1-1/4"	.344	2.88"	10	10.8	24"	20'	134	89	67	54	36	27
				20	15.2	25'	151	101	76	60	40	30	
				30	18.7	29'	160	106	80	64	43	32	
				40	21.6	32'	168	112	84	67	45	34	
				10	10.8	30"	21'	128	85	64	51	34	26
				20	15.2	27'	140	93	70	56	37	28	
				30	18.7	31'	150	100	75	60	40	30	
				40	21.6	34'	158	105	79	63	42	32	
				10	10.8	36"	21'	127	85	64	51	34	26
				20	15.2	28'	134	89	67	54	36	27	
				30	18.7	33'	140	94	70	56	37	28	
				40	21.6	36'	149	99	74	60	40	30	

TABULATION IS BASED ON SPRAYING WATER AT TEMPERATURE OF 70°F.
COVERAGES ARE BASED ON RIG BEING IN MOTION AT SPEEDS LISTED.

PSI = LIQUID PRESSURE IN LBS. PER SQ. INCH
GPM = CAPACITY IN GALLONS PER MINUTE
W = SPRAY COVERAGE IN FEET
MPH = SPEED IN MILES PER HOUR

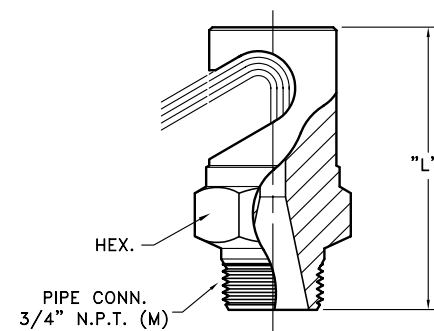

3/4KLC-- NOZZLES ARE AVAILABLE IN BRASS AND STAINLESS STEEL.

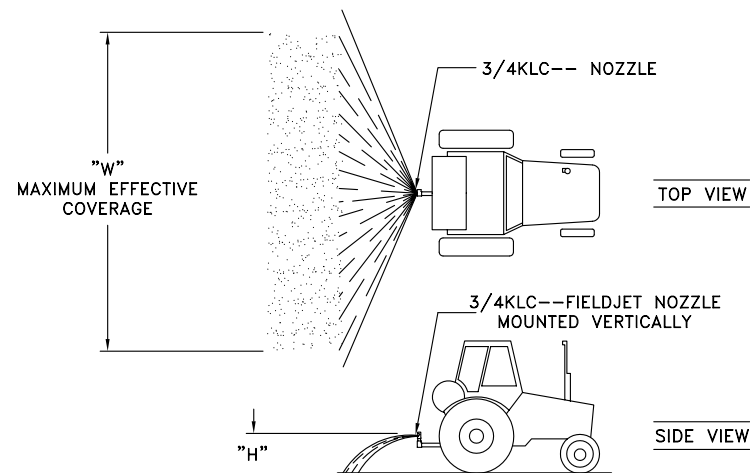

DESCRIPTION:
GALLONS PER ACRE
3/4KLC-- FIELDJET® NOZZLES



Spraying Systems Co.®

Spray Nozzles and Accessories
P.O. Box 7900 - Wheaton, IL 60189-7900

Rev. No. 1

Ref.

DATA SHEET

6797-1

SHEET OF