

FEATURES:

- MATERIALS: CAP – NYLON
SEAT GASKET – EPDM
(VITON OPTIONAL)
- MAXIMUM PRESSURE – 300 PSI (20 bar)
- MAXIMUM TEMPERATURE – 100° F (38° C)
- DESIGNED FOR USE WITH LECHLER ID TIP.
SPRAY TIPS AND SPRAYING SYSTEMS CO.
QUICK TEEJET® BODIES.

FOR USE WITH

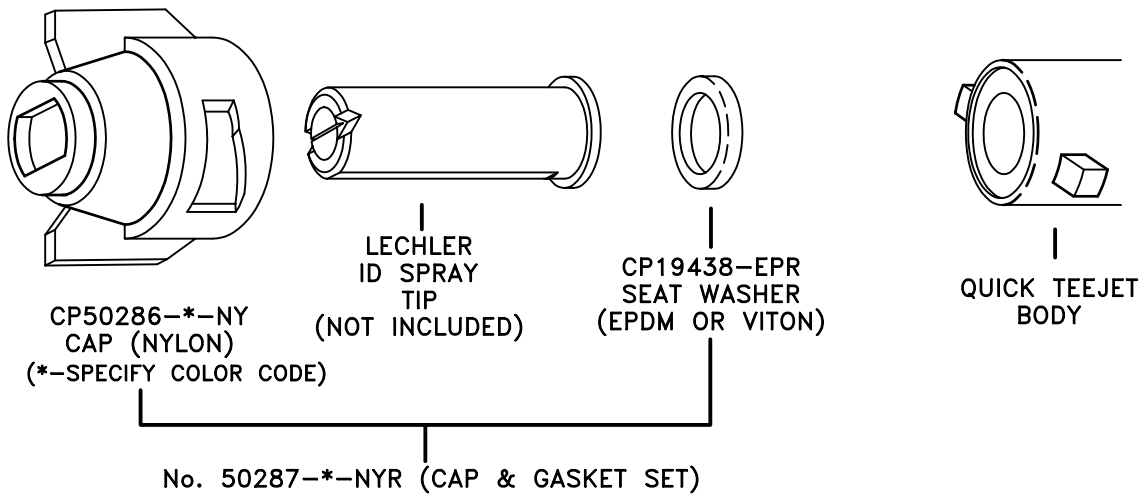

| Colors of Caps | Color Code | Colors of Caps | Color Code |
|----------------|------------|----------------|------------|
| Black | 1 | Green | 5 |
| White | 2 | Yellow | 6 |
| Red | 3 | Brown | 7 |
| Blue | 4 | Orange | 8 |

DESCRIPTION:

CP50286-*--NY
QUICK TEEJET CAP
TO ACCEPT LECHLER SPRAY TIP



Spraying Systems Co.®

Spray Nozzles and Accessories
P.O. Box 7900 – Wheaton, Il. 60189-7900

Rev. No. 1

Ref.

Data Sheet No.

50286

SHEET OF