

FEATURES:

- MATERIAL: CAP - CELCON
SEAT GASKET - EPDM
- MAXIMUM PRESSURE - 150 PSI (10 bar)
- MAXIMUM TEMPERATURE - 100° F (38° C)
- DESIGNED TO FIT HARDI SNAP FIT NOZZLE BODIES.

FOR USE WITH

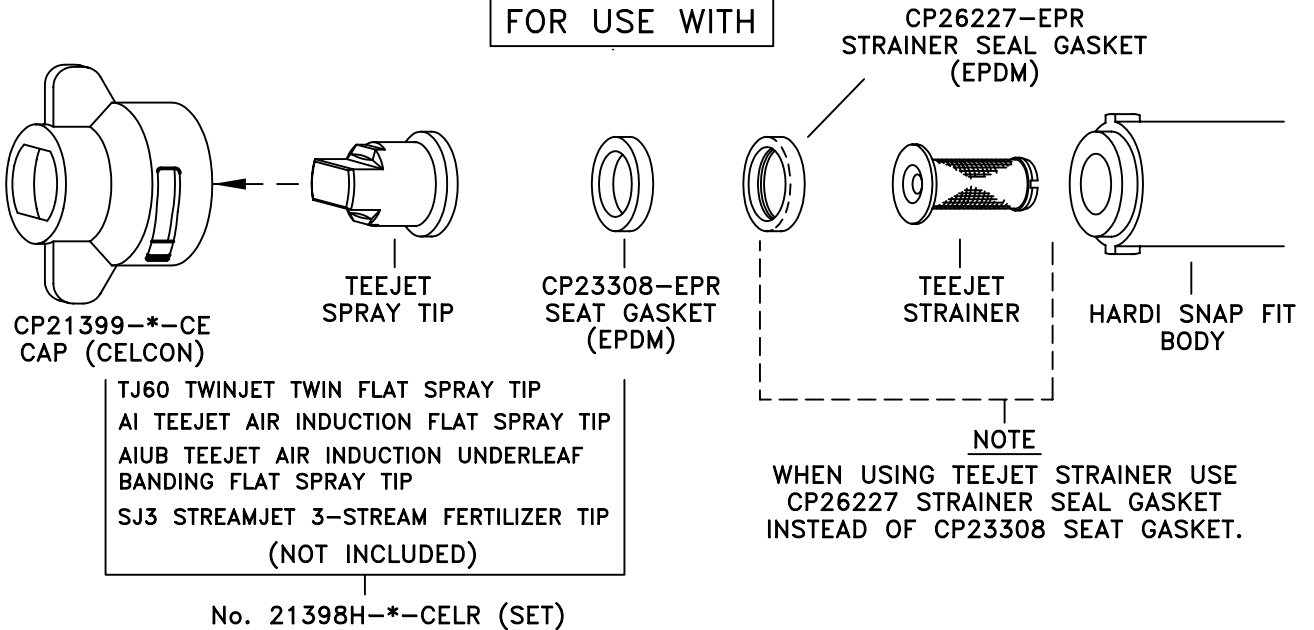

*SPECIFY COLOR CODE (SEE CHART)

HOW TO ORDER:

COLR OF CAP	COLOR CODE
BLACK	1
WHITE	2
RED	3
BLUE	4
GREEN	5
YELLOW	6
BROWN	7
ORANGE	8

FOR CAP AND SEAT GASKET SET, SPECIFY SET NO. AND COLOR CODE.
EXAMPLE: 21398H-6-CELR

FOR CAP ONLY, SPECIFY PART NO. AND COLOR CODE.
EXAMPLE: CP21399-6-CE

FOR SEAT GASKET, SPECIFY PART NO.
EXAMPLE: CP23308-EPR

FOR STRAINER SEAL GASKET, SPECIFY PART NO.
EXAMPLE: CP26227-EPR

DESCRIPTION:

NO. 21398H---CELR
CAP AND SEAT GASKET
FOR HARDI SNAP FIT BODY



Spraying Systems Co.[®]

Spray Nozzles and Accessories
P.O. Box 7900 - Wheaton, Il. 60189-7900

Rev. No. 2

Ref.

DATA SHEET

21398

SHEET OF