

ITEM	PART NO.	DESCRIPTION
1A	19121-406-NYB	SINGLE HOSE SHANK BODY SUB-ASSEMBLY, NYLON (BLACK)
	19121-540-NYB	" " " " " " " " " "
	19121-785-NYB	" " " " " " " " " "
1B	19122-406-NYB	DOUBLE HOSE SHANK BODY SUB-ASSEMBLY, NYLON (BLACK)
	19122-540-NYB	" " " " " " " " " "
	19122-785-NYB	" " " " " " " " " "
1C	19123-406-NYB	TRIPLE HOSE SHANK BODY SUB-ASSEMBLY, NYLON (BLACK)
	19123-540-NYB	" " " " " " " " " "
	19123-785-NYB	" " " " " " " " " "
2	CP21953-EPR	DIAPHRAGM, EPDM RUBBER (STANDARD)
	CP21953-VI	DIAPHRAGM, VITON (OPTIONAL)
3	21950-10-NYB	ChemSaver END CAP ASSEMBLY, NYLON (BLACK)
4A	19349-211-406-NYB	SINGLE HOSE SHANK BODY & ChemSaver SUB-ASSEMBLY, NYLON (BLACK)
	19349-211-540-NYB	" " " " " " " " " "
	19349-211-785-NYB	" " " " " " " " " "
4B	19350-212-406-NYB	DOUBLE HOSE SHANK BODY & ChemSaver SUB-ASSEMBLY, NYLON (BLACK)
	19350-212-540-NYB	" " " " " " " " " "
	19350-212-785-NYB	" " " " " " " " " "
4C	19351-213-406-NYB	TRIPLE HOSE SHANK BODY & ChemSaver SUB-ASSEMBLY, NYLON (BLACK)
	19351-213-540-NYB	" " " " " " " " " "
	19351-213-785-NYB	" " " " " " " " " "

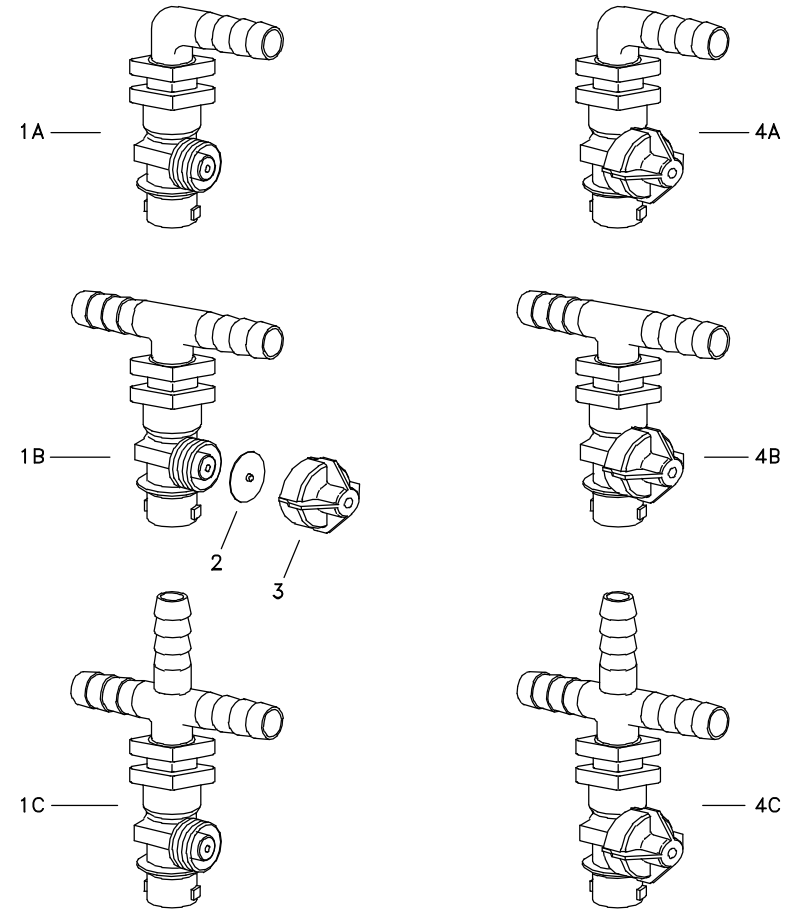

DESCRIPTION:  
NO. QJ200 SERIES HOSE SHANK  
DIAPHRAGM CHECK VALVES



**Spraying Systems Co.**  
Spray Nozzles and Accessories  
P.O. Box 7900 - Wheaton, IL 60189-7900

Rev. No.

Ref.

Parts List No.  
**PL QJ200**  
SHEET OF